

# EXHIBIT B

NOTES:

1. REFER TO ROOF PLAN FOR OVERALL BUILDING DIMENSIONS.

2. THE EXTERIOR ELEVATIONS, INCLUDING DOOR AND WINDOW SIZES AND LOCATIONS, THE INTERIOR PARTITION LOCATIONS, THE NUMBER, SIZE, AND LOCATIONS OF RESIDENTIAL UNITS, OUTDOOR SPACE, STAIRS, BALCONY AND ELEVATORS ARE PRELIMINARY AND SHOWN FOR ILLUSTRATIVE PURPOSES ONLY. THE PARKING SPACE LAYOUT IS SHOWN FOR ILLUSTRATIVE PURPOSES ONLY. THE FINAL LAYOUTS MAY VARY.

3. ALL SPOT ELEVATIONS ARE RELATIVE TO THE MEASURING POINT +84.28' TAKEN AT THE CENTER OF THE 4TH STREET CURB, ASSUMED FOR THESE DRAWINGS TO BE +0'-0".

4. APPLICANT REQUESTS FLEXIBILITY TO MODIFY ROOF STRUCTURES TO INCLUDE ADDITIONAL SPACE FOR RESIDENTIAL OCCUPANCY PENDING CONGRESSIONAL APPROVAL OF AMENDMENTS TO THE HEIGHT ACT OF 1910. APPLICANT WILL PROVIDE FURTHER DETAIL OF ROOF STRUCTURE PROPOSALS IN SUBSEQUENT SUBMISSIONS.

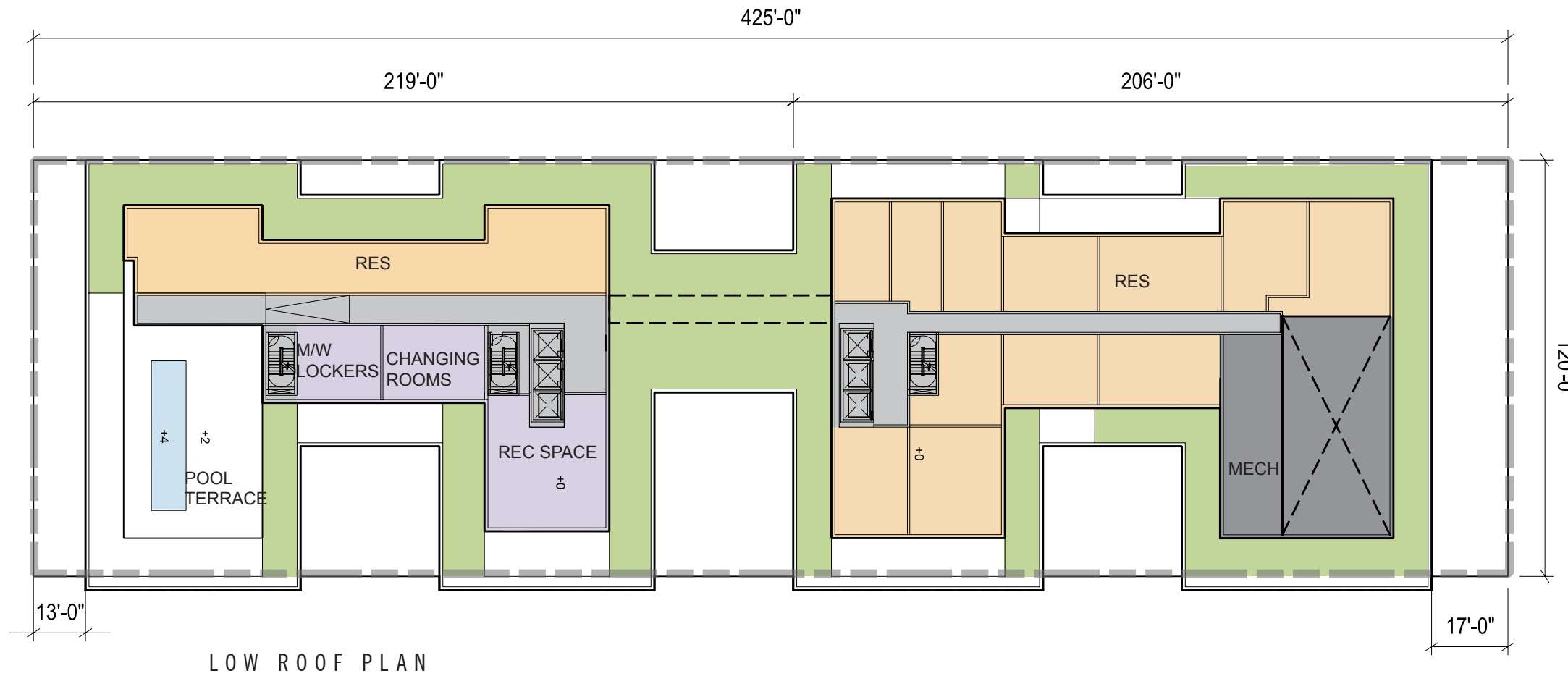

LOW ROOF PLAN

LEGEND

- CORE/ CIRCULATION
- MECHANICAL
- RES RECREATION
- RES MECHANICAL
- GREEN ROOF